

Using Shield Force Plus with exposed dentin and direct restorations

1 Exposed Cervical Dentin: Treatment of Dentinal Hypersensitivity

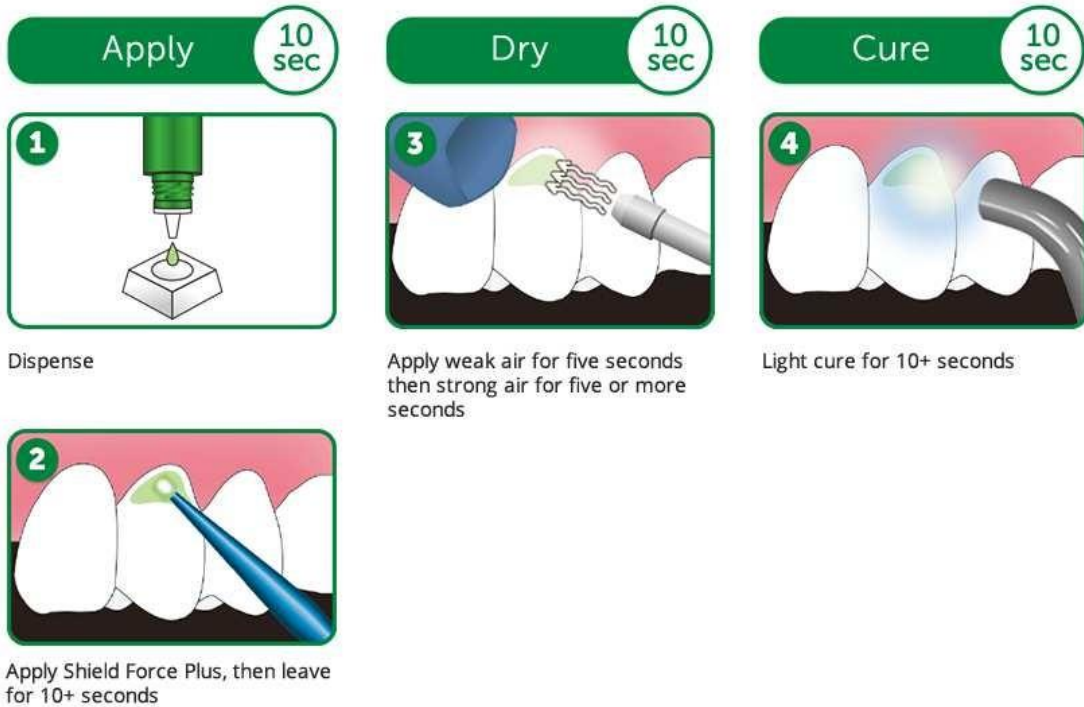

2 Direct Restorations: Sealing of Prepared Tooth to Alleviate/Prevent Tooth Sensitivity

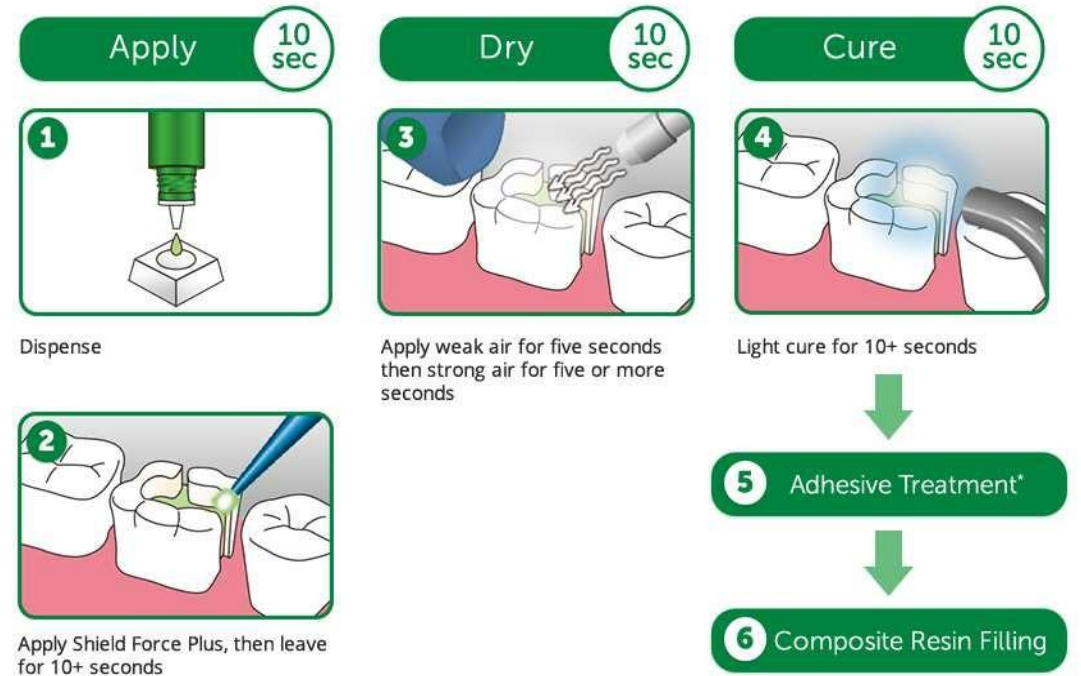

*If using a **total etch bonding system**, etchant must be applied "AFTER" Shield Force Plus procedure.

Using Shield Force Plus with indirect restorations

3 Indirect Restorations: Sealing of Prepared Tooth to Alleviate/Prevent Tooth Sensitivity

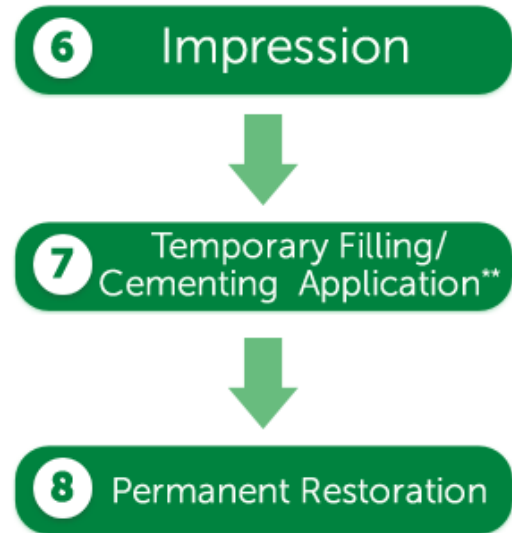

*BEFORE taking impression, it is essential to wipe dentin surface with alcohol, removing unpolymerized layer of Shield Force Plus that could prevent an accurate impression.

Do **NOT use temporary resin-based material, it may adhere to the cured Shield Force Plus. The use of water-based cement would be recommended for temporary cementing, and temporary stopping would be recommended for temporary filling.